

Bog nr. 58

58

THE COMPLETE OFFICIAL MGB 1975–1980

Comprising the Official

Driver's Handbook
Workshop Manual

The Complete Official MGB: 1975-1980

304 photos, 419 illustrations

This manual was prepared in close cooperation with British Leyland Motors in order to provide complete, authentic maintenance and repair information. The Driver's Handbook, which comprises the first part of this manual, is the handbook which was provided with every new MGB. The Workshop Manual, which comprises the second—and largest—portion of this manual, is the official factory manual. This manual contains emission control information that applies specifically to

MGBs manufactured for the US market, and a complete, illustrated catalog of special tools.

Including the most up-to-date, accurate, and comprehensive service information available for 1975-1980 MGBs, this manual is an indispensable resource for both the professional mechanic and the MGB enthusiast. The publisher has incorporated additional factory procedures and specifications that have become available following the publication of the original factory information.

Contents

Part I Official MGB Convertible Handbook:

Foreword	Page 2
Catalytic Converter Precautions	3
Controls	3
Instruments and Switches	4
Starting and Running Instructions	9
Locks, Fittings and Body	12
Seats and Seat Belts	17
Heating and Ventilating (1975-1976)	18
Heating and Ventilating (1977 and later)	19
Cleaning	20
Cooling System (1975-1976)	20
Cooling System (1977 and later)	21
Wheels and Tires	23
Brakes and Master Cylinders	24
Electrical	26
Ignition	33
Engine	35
Emission Control Systems	36
Fuel Systems	40
Transmission	41
Steering/Suspension	42
General Data	43
Maintenance Summary	44
Lubrication	48
Service	50

Part II Official MGB Convertible Workshop Manual:

General Specification Data	Page 57
Engine Tuning Data (1975-1976 without Catalytic Converter)	65
Engine Tuning Data (1976 and later without Catalytic Converter)	66
Torque Wrench Settings	67
General Fitting Instructions	69
Service Lubricants, Fuel and Fluids	73
Maintenance	75
The Engine	101
The Ignition System	121
The Cooling System	127
The Fuel System	131
The Clutch	145
The Gearbox (All Synchromesh)	153
The Overdrive (Type L.H.)	161
The Propeller Shaft	175
The Rear Axle and Rear Suspension (Semi-Floating Type)	181
The Steering Gear	193
The Front Suspension	199
The Braking System	207
The Electrical System	219
Wiring Diagrams	235
The Body	247
Service Tools	263
Emission Control	281

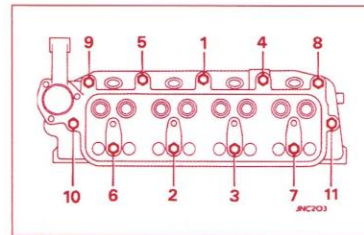

Cylinder head nut slackening and tightening sequence, page 103

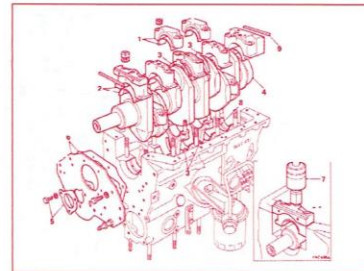

Removing the crankshaft, page 112

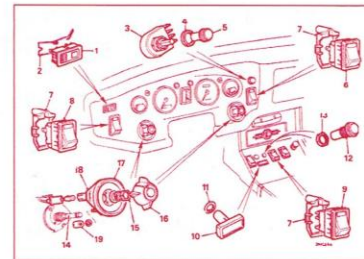

The switches, lamps, and controls, page 230

Complete coverage of the following models sold in the United Kingdom and in North America during model years 1975-1980:

1975 18V 797AE Standard
18V 798AE Overdrive

1976 18V 797AE Standard
18V 798AE Overdrive
18V 801AE Standard with Catalytic Converter
18V 802AE Overdrive with Catalytic Converter

1977 through 1980

18V 883AE Standard with Catalytic Converter
18V 890AE Standard with Catalytic Converter
18V 884AE Overdrive with Catalytic Converter

Bentley Stock No. X112
ISBN 0-8376-0112-6